

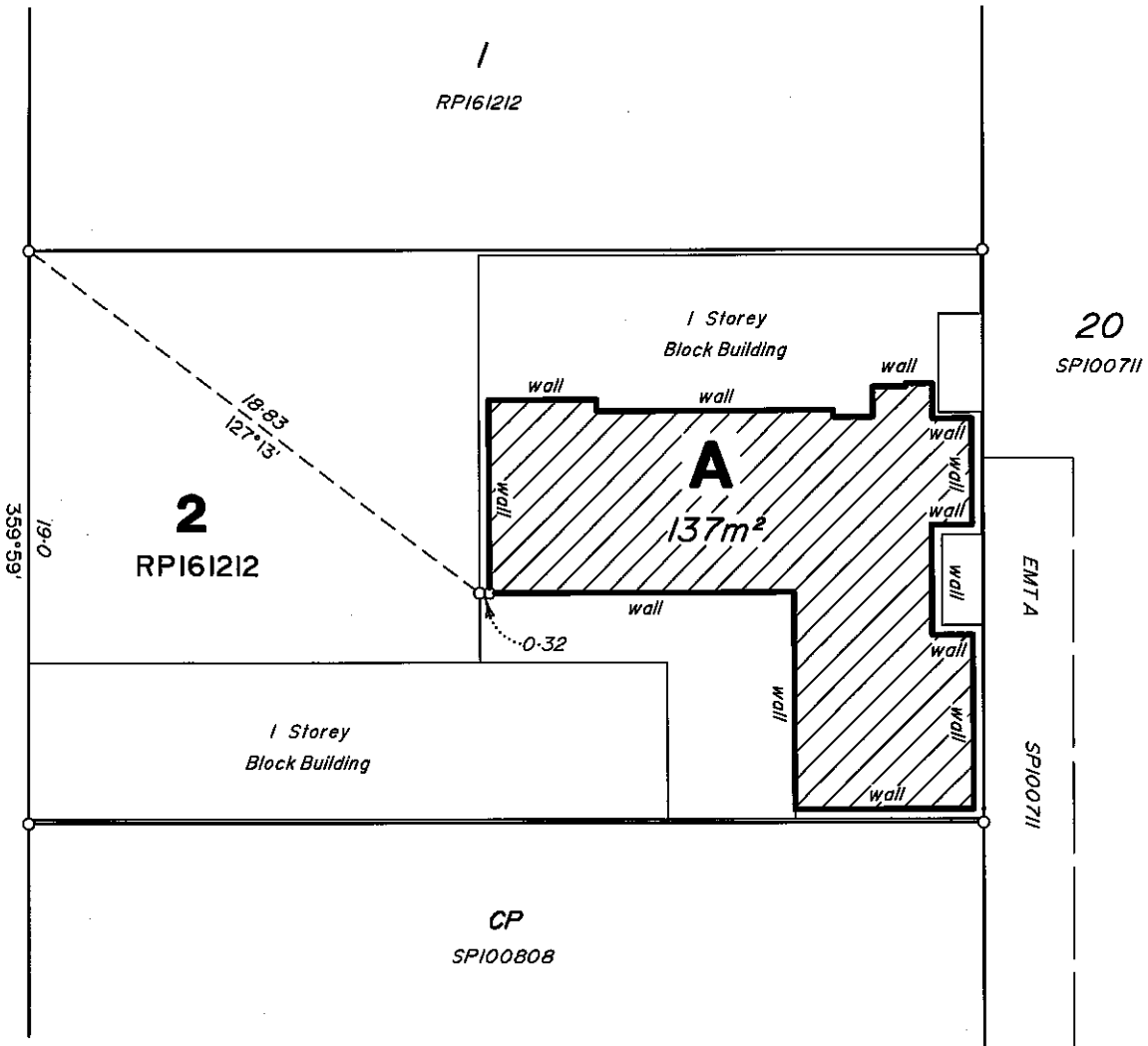

THOMAS STREET



Ken Hicks & Associates Pty Ltd (ACN 101 278 823),
Cadastral Surveyor, certify that the details shown
on this sketch plan are correct.

Director _____

Director _____

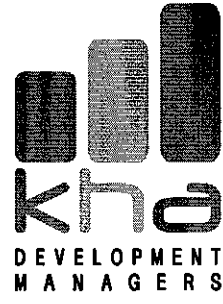
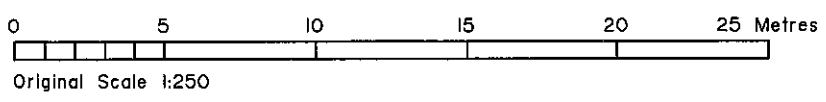
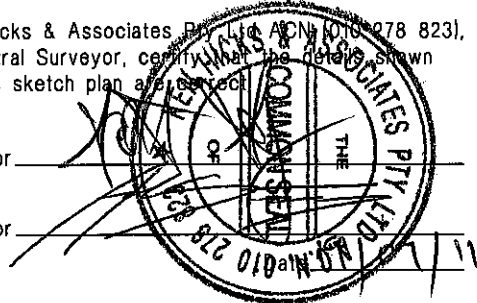

PLANNING | SURVEYING | PROJECT MANAGEMENT | COURT APPEALS

Sunshine Coast
PI 07 5443 2844 FI 07 5443 7146

Brisbane
PI 07 3262 1200 FI 07 3262 1499

North Queensland
PI 07 4721 3066 FI 07 4721 3088

Info@kenhicks.com.au
Ken Hicks & Associates Pty Ltd ACN 010
278 823 ABN 74 308 406 611 trading as
KHA Development Managers

LEASE A			
BEING PART OF THE GROUND FLOOR OF A BUILDING ERECTED ON LOT 2 ON RP161212			
P.C.A. 1997, GROSS LETTABLE AREA - RETAIL (GLAR)			
PARISH WEYBA	COUNTY MARCH	TITLE REF 15768008	
SCALE 1:250	DATE 19/07/2011	DRAWING No 11287.1	AMEND