

**DIAGRAM**

Not To Scale

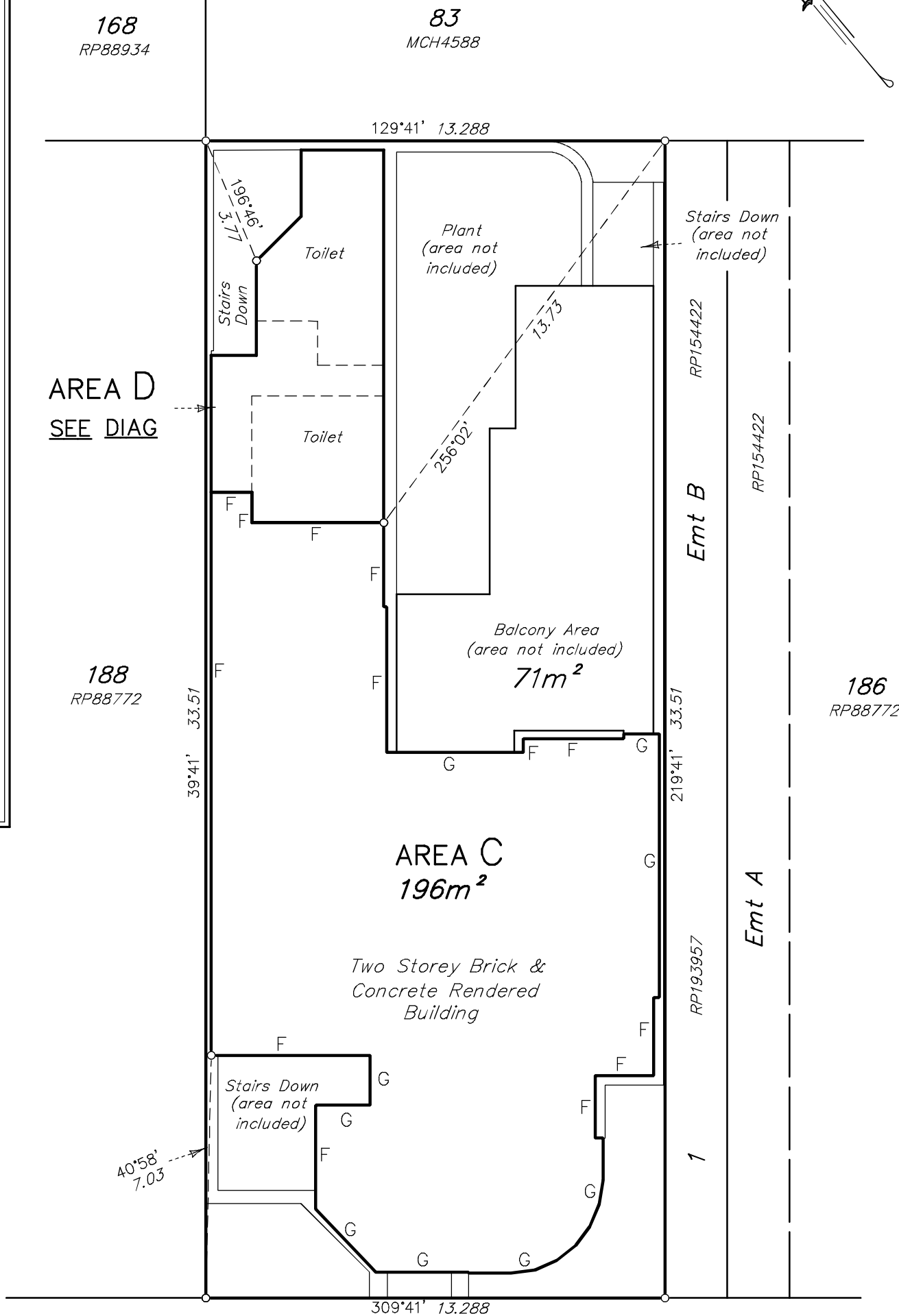
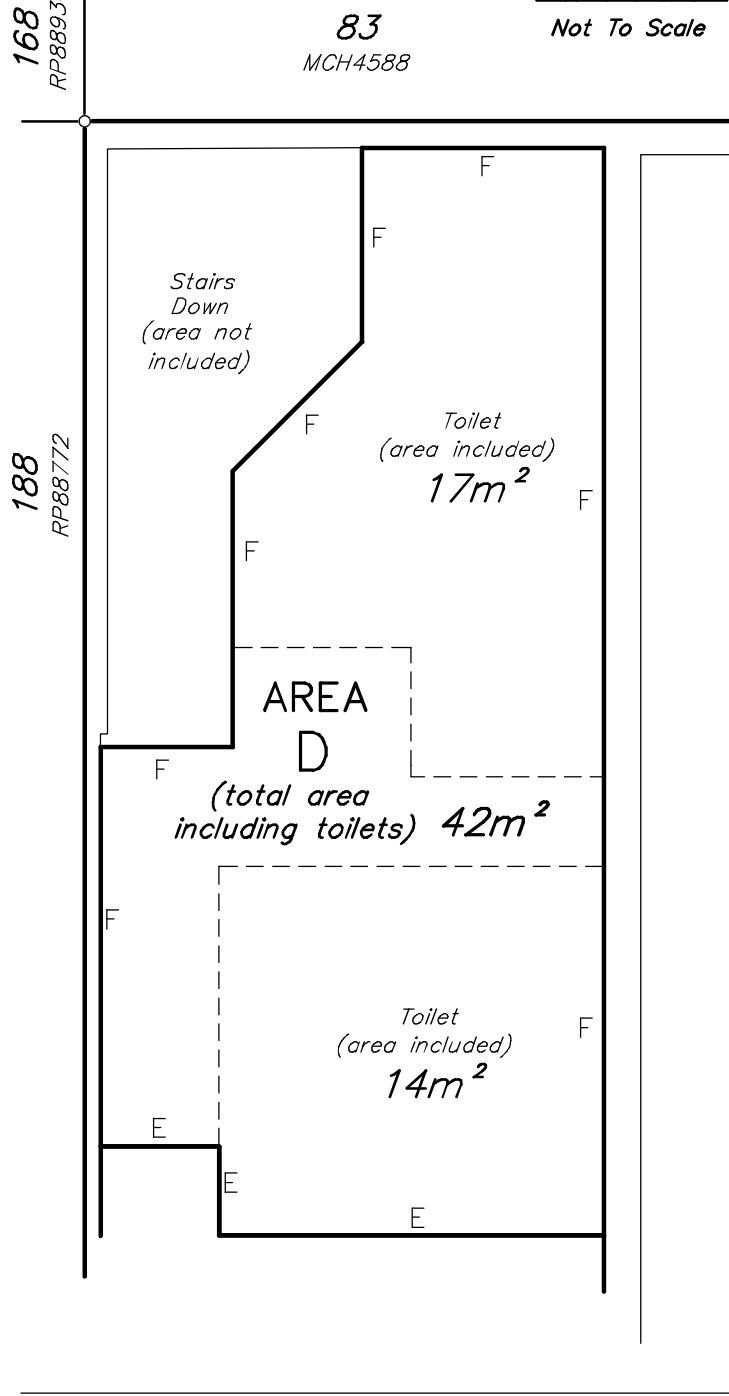

**Legend**

- F - denotes internal face of finished wall
- G - denotes internal face of glass
- E - denotes external face of wall

The boundary information shown has been compiled from RP193957 in the Dept of Natural Resources and Mines and has not been marked at the time of survey

**GROSS LETTABLE AREA RETAIL**

The area expressed on the face of this plan is the Gross Lettable Area Retail as defined by the "Property Council Of Australia Method of Measurement" .... March 1997 Issue

**SUNSHINE BEACH ROAD**

Scale 1:150 Lengths are in Metres

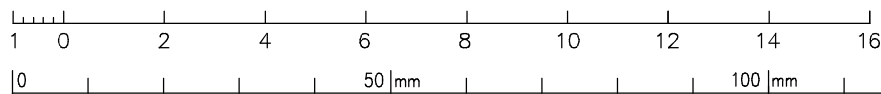

We, RUBEL PTY LTD A.B.N. 86 715 462 055 (t/a Hidden Equity Specialists), Cadastral Surveyor, certify that the details shown on this sketch plan are correct.

*[Signature]* 30/06/2014  
Director/Cadastral Surveyor Date

**PLAN FOR LEASE PURPOSES**  
Being part of the First Floor of  
a Building on Lot 2 on RP193957  
(23 Sunshine Beach Road, Noosa Heads)  
(Areas C & D)



PO Box 1212, Caloundra Qld 4551  
Phone: 0428 277 670

Surveyed: RAF  
Date of survey: 27/06/2014

Drawing No: 4775-02

PARISH: **WEYBA**

COUNTY: **March**

Meridian: **RP193957**

Locality: **NOOSA HEADS**

Scale: **1:150 @ A3**